

## Monitor® AW

### INSTRUCTION MANUAL AT-THE-WELL PLUG-IN CONTROL KIT FOR RECIPROCATING PUMPS

#### GENERAL

This manual applies to control kits with the following ordering numbers:

**(2-8) 0AWRPA**  
**(2-8) 0AWRA**

#### INSTALLATION

Follow the instructions for installing the Monitor Pitless Unit up to the point where the spool is attached to the drop pipe. Then proceed with the following, (numbers in "( )" refer to Figure 3).

1. Remove 3/8" pipe plug from spool.
2. Dope threads of female plug-in fitting (11) and screw into spool.
3. Lower spool into pitless case.
4. Rivet or screw lift-out bar (6) to control assembly.
5. Lubricate "O" rings (10) with Vaseline.
6. Lower control assembly into pitless unit and plug in. When the control is being plugged in, the lift out bar (Fig. 1) should be turned at right angles to the side of the pitless case (Fig. 1). **CAUTION:** Avoid twisting or kinking tube.

7. Remove jam nut (3), cap and rubber gasket that holds fluid in tube, from upper brass fitting and then slide fitting through 5/8" hole in pitless unit cap. Replace jam nut and tighten. **NOTE:** Loss of fluid may cause switch to react inconsistently.
8. Slip cap over drop pipe onto case and secure.
9. Dope threads of upper brass fitting and then screw on pressure switch (2). **CAUTION:** Overtightening of pressure switch may crack hex portion of switch.
10. Connect electrical wiring. (Turn over pump by hand to check for correct adjustment). Turn on pump and operate for several minutes, then check for fluid leaks.
11. Check pressure switch setting.

#### TROUBLE-SHOOTING

**CAUTION:** Never remove pressure switch without first releasing all water system pressure. Not releasing all water system pressure will cause a loss of control fluid.

#### Loss of Control Fluid may be caused by:

- A. A leak between switch and upper brass fitting.  
**Remedy:** Leaks can be eliminated by use of plastic pipe dope on threads.
- B. Loose pressure switch diaphragm.  
**Remedy:** Tighten screws that hold diaphragm.
- C. Cracked hex portion of pressure switch.  
**Remedy:** Replace switch.

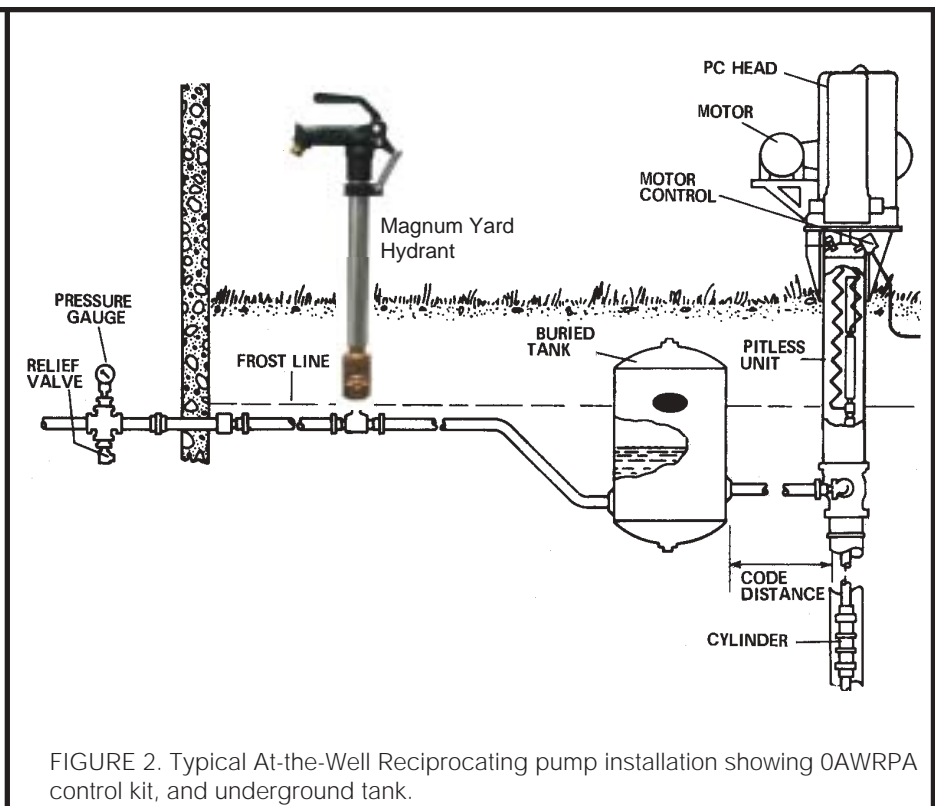
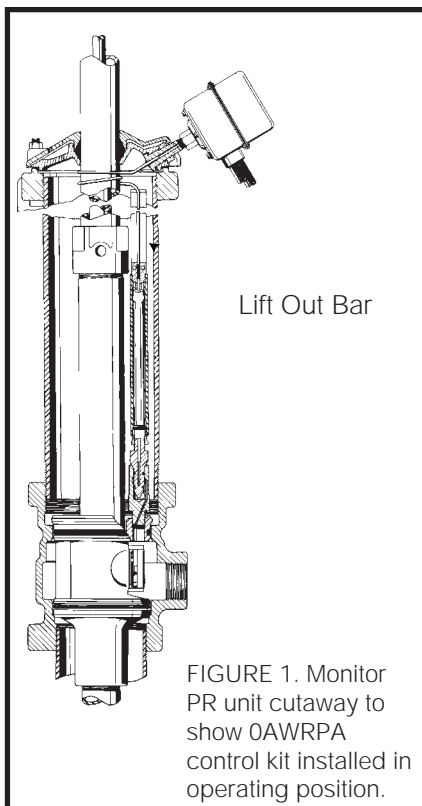

## AW Controls

### Cycling of pressure switch may be caused by:

- A. Too small a discharge line.  
**Remedy:** Replace line, install buried tank or use smaller cylinder.
- B. Water-logged pressure tank.  
**Remedy:** Replace mechanical air volume control with float and/or drain or pressure charge tank.
- C. Inadequate differential setting on pressure switch. **Remedy:** Increase setting until cycling stops.

### Refilling Control with Fluid

1. Disconnect wires, remove switch and then re-connect wires to pump.
2. Start pump and run until fluid is visible at the top of the upper brass fitting (It will not be necessary to exceed 40 or 45 PSI).
3. Screw a 1/4" pipe coupling onto the brass fitting and then screw a piece of 1/4" pipe approximately 20" long into coupling and fill with Monitor pressure control fluid. NOTE: 3/8" I.D. plastic or rubber tubing may be used instead of the pipe.
4. Release system pressure and wait several minutes after the system pressure registers "O" PSI before removing the tube or fittings.
5. Place pipe dope on the brass fitting and replace pressure switch.

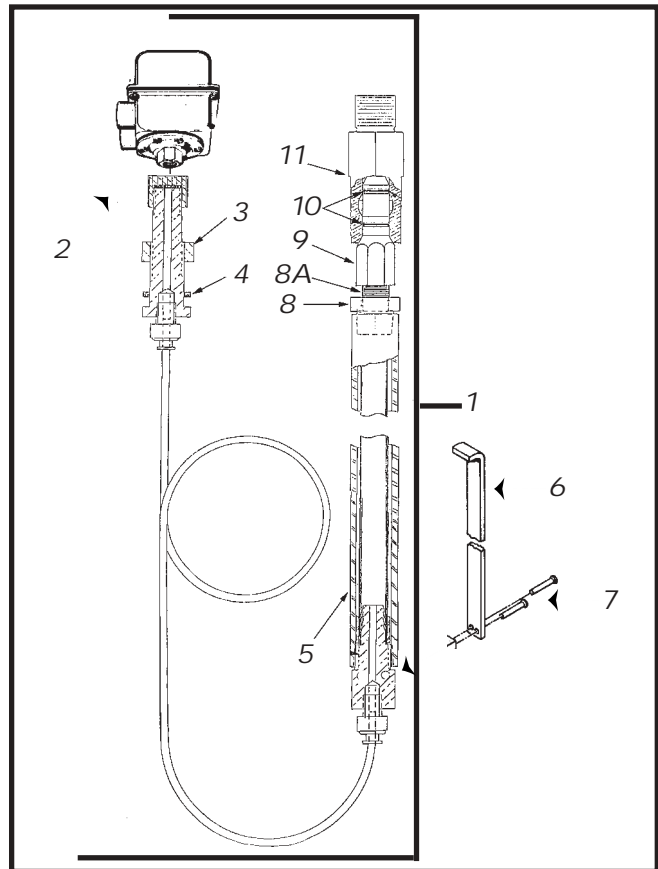

FIGURE 3 EXPLODED VIEW OF AWRPA CONTROL KIT

**If extension from male brass fitting is required, this also must be filled with fluid.**

**NOTE: If tank is installed beyond 15' of control, use at your own risk.**

**NOTE: Pressure relief valve is recommended on all installations - 120 PSI maximum.**

Model No.			0AWRPA
Item	Qty	Description	Ord. No.
1	1	Plug-in Control Kit with pressure switch	0AWRPA
1	1	Same as above, w/o pressure switch	0AWRA
2	1	Pressure switch	0AWP
3	1	Hex head jam nut 5/8"-18NF	PS9
4	1	Gasket	PS2
5	1	Tube housing	PS15A
6	1	Lift-out Bar - 2'	2PR
		Lift-out Bar - 3'	3PR
		Lift-out Bar - 4'	4PR
		Lift-out Bar - 5'	5PR
		Lift-out Bar - 6'	6PR
		Lift-out Bar - 7'	7PR
		Lift-out Bar - 8'	8PR
7	2	Rivets	PR3
8	1	Reducer Bushing 3/8" x 1/4"-NPT	PR4
8A	1	Galv. Nipple 3/8" x 1/2"	PS181
9	1	Male plug-in fitting	PR1A
10	2	"O" ring	PS27
11	1	Female plug-in fitting	PS44