

# FROST-PROOF HYDRANT

Monitor Hydrant is the only hydrant with all of these features!

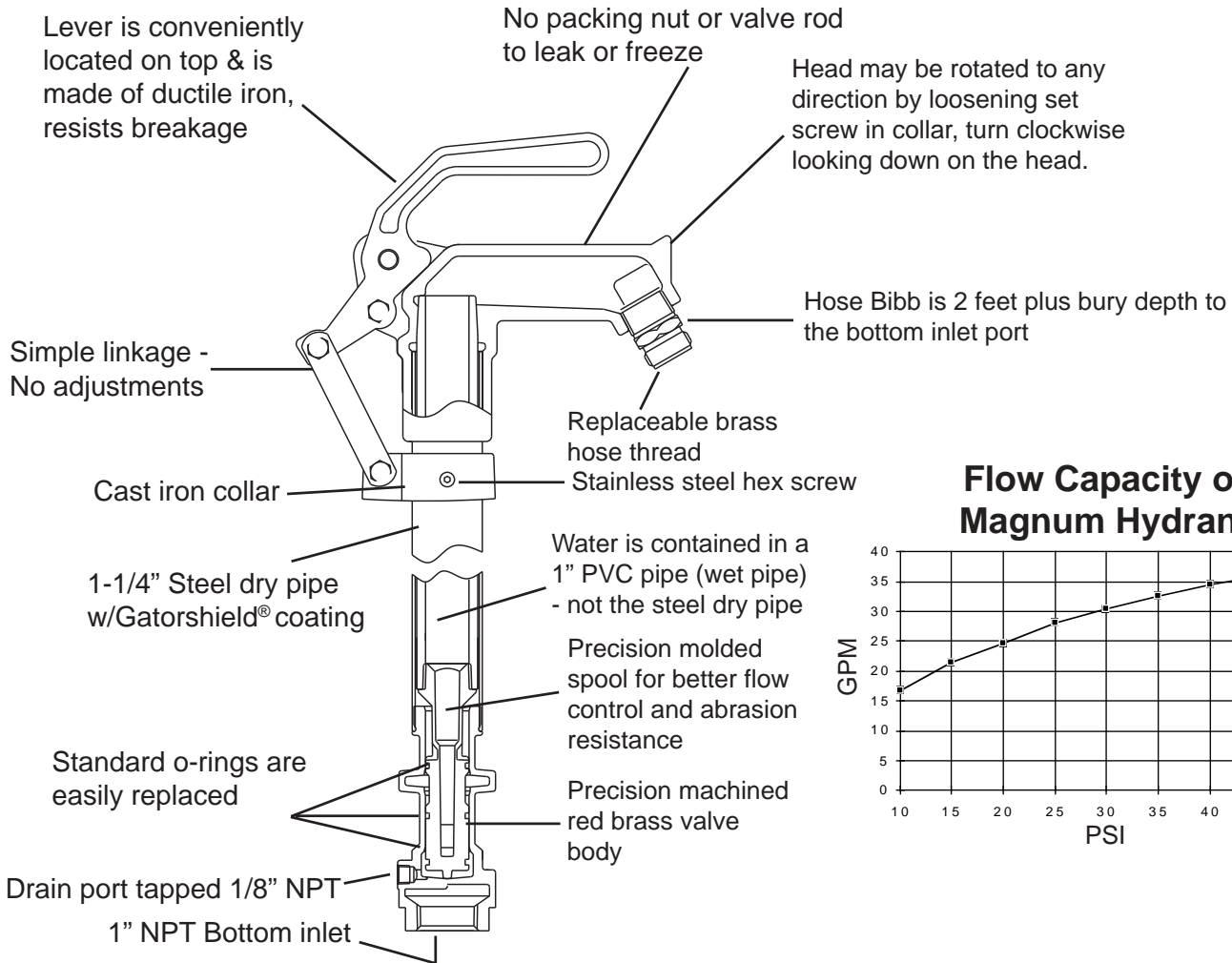

**Flow Capacity of  
Magnum Hydrant**

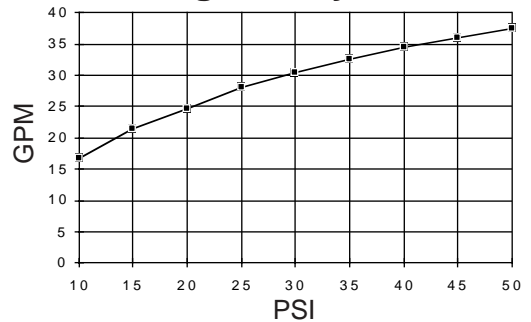

## INSTALLATION

Proper installation is essential for satisfactory operation of any hydrant, regardless of make. **Adequate provision must be made for proper drainage in cold weather and this is best accomplished by the use of an adequate bed of gravel or pea rock, under and around hydrant.** Plastic sheeting placed over gravel will prevent seepage of dirt into gravel to plug the spaces. If ground water table is high or hydrant elevation is lower than supply line you **must** run a drain tile from vicinity of hydrant.

Patent #6,178,988 B1

## MAINTENANCE

The absence of adjustments, plus the unique construction of your Monitor Hydrant makes maintenance very simple and easy. The only parts requiring replacement, under normal conditions, will be the three O-rings. No large pipe wrenches needed.

### TO REPLACE O-RINGS

1. Turn off the water supply.
2. Loosen the hex screw in the collar.
3. Pull out PVC wet pipe.
4. Replace o-rings.
5. Apply a thin coat of vaseline on the o-rings.
6. Hydrant stand pipe **must** be completely drained.
7. Install wet pipe back in hydrant stand pipe.
8. Handle **must** be in closed position.
9. Bottom out the head casting on the stand pipe.
10. Rotate the head casting outlet clockwise looking down on the head to the direction you want it.
11. Make sure collar is perpendicular with stand pipe.
12. Tighten hex screw - Do Not Overtighten.



# FROST-PROOF HYDRANT

## IMPORTANT NOTICE

When using a garden hose, an automatic vacuum breaker must be installed.

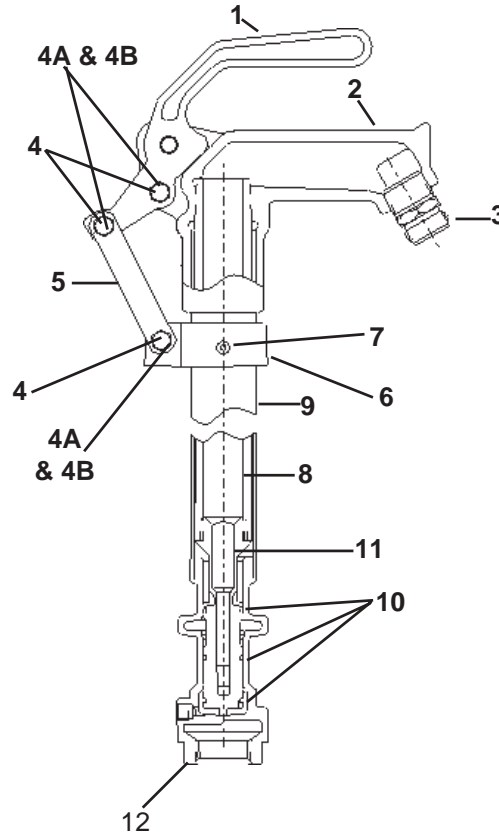

Item	Qty	Description	Model No.
1	1	Handle	H215D
2	1	Head Assembly (Includes Items 1 thru 7)	10-174A
3	1	Hose Adapter-NPT	H211A
4	3	Bolt 1/4-20X1.25	E90HC1.2
4A	3	Nut 1/4-20 Locking	DP49W
4B	2	Washer 1/4" Flat	UN243W
5	2	Linkage straps	H228
6	1	Collar	H230AFRO
7	1	Set Screw only 5/16UNCX.375 SS	PS355W1
8	1	Wet Pipe	WTPT*
9	1	Dry Pipe Kit	DRPT*
10	3	O-rings - 115 PTFE coated	SE2115N71
11	1	Spool & O-Rings	H220DA
12	1	Brass Valve Body	H222WMFRO

\*Add appropriate bury depth after this part number (example: -1 for 1 foot or -2 for 2 foot etc.)

Patent #6,178,988 B1

